



## CALL FOR QUALIFICATIONS FOR JOHNSON CITY, TENNESSEE SESQUICENTENNIAL SCULPTURE

---

The Public Art Committee of Johnson City, Tn. is seeking qualifications from artists or art teams for the commission of a sculpture to commemorate the City's sesquicentennial and to celebrate the City's future evolution.

**ELIGIBILITY:** This opportunity is open to all professional artists over the age of 18 with previous public sculpture experience. Refer to the Selection Criteria listed below for additional requirements.

**BUDGET:** Up to three finalists will be selected to develop concept proposals for this project. The total project budget for the selected commission is not to exceed \$150,000. Each finalist will be paid a \$1,000 stipend for his/her proposal. The selected artist/art team will be paid up to \$147,000 for the commissioned work. The selected artist/art team will be responsible for own travel costs, materials, housing, and personal liability insurance. Finalists will be required to present their work to the Selection Committee and will be reimbursed for travel costs and hotel accommodations.

**DEADLINE:** April 19, 2019

**QUESTIONS:** Cheyenne Kumbhare [ckumbhare@johnsoncitytn.org](mailto:ckumbhare@johnsoncitytn.org) 423-975-2706

## **JOHNSON CITY:**

**Johnson City, with an elevation of over 2000 feet, is located in the foothills of the Appalachian Mountains. It is surrounded by farmland, undulating hills, lush valleys, and many lakes and rivers. Johnson City has an abundance of unspoiled natural beauty and four distinct seasons.**

**The eighth-largest city in Tennessee, with a population of 66,000, Johnson City was founded in 1856 and later became a major rail hub for the Southeast.**

**Johnson City is distinguished as a community that embraces art, the environment, commerce, science, community, and education. It is home to a broad based economy and to East Tennessee State University. The City houses a healthy blend of residents, ranging from college students and young families to those of retirement age. Many locate to the area due to its proximity to the mountains and its pleasant climate. Johnson City residents and visitors have enjoyed a large amount of nearby outdoor recreation opportunities for many years, but these opportunities have recently been promoted on a wider scale in an effort to enhance tourism and economic development. In 2018, the City was voted the “Top Adventure Town” for a mid-sized city by *Blue Ridge Outdoors*.**

**New developments in downtown Johnson City reflect this emphasis on outdoor recreation as two new parks in the downtown have provided much needed green space as well as community gathering spaces for the City. The amount of downtown events has multiplied since the parks were developed, and the number of downtown visitors has also grown tremendously. The City’s downtown has been in the midst of a revitalization period for the past ten years as additional restaurants, breweries, and businesses have located to the area. This has enhanced the downtown nightlife while increasing the amount of foot traffic as college students and others flock to the area for a variety of purposes. Several historic buildings have been renovated and leased, and this trend is expected to continue. Public art has played a role in the revitalization and has especially enlivened the parks through the incorporation of sculpture, murals, and artistic public infrastructure projects. Artistic traffic wraps and quote stones can also be found throughout the downtown.**

**The City welcomed the development of a pedestrian/bike trail and a mountain bike park in recent years, both of which are adjacent to the downtown area. The trail, known as the Tweetsie Trail, connects Johnson City and Elizabethton and follows a former railroad right-of-way between the two locations. The mountain bike park is nearing completion with more than four miles of biking and hiking trails. The park is located at Tannery Knobs, a rugged, forested area that overlooks the downtown. The artist is encouraged to conduct further research into the history of Johnson City.**

## **KING COMMONS PARK:**

The sesquicentennial sculpture will be installed in the recently developed King Commons park in downtown Johnson City. The park was created to restore and enhance a portion of the Brush and King Creek watersheds by allowing for increased storm water storage capacity. It includes features such as terraced grass areas with stone seat walls, on-street parking utilizing permeable pavers, a loop trail, glowing pathway, LED lighting, plaza areas, and native landscaping. The park design focuses on sustainability, storm water mitigation, and pollination.

Current art pieces within the park include a colorful, dynamic mural on an adjacent building and a set of artistic bridge railings that wind their way throughout the park. The mural displays native flora and fauna and provides a unique sense of place through the incorporation of architectural landmarks within Johnson City. The bridge railings follow a similar theme and feature native flowers and bees in their design. The emphasis on native plants and pollination stems from a concerted effort to raise awareness about the decline of pollinators and pollinator friendly habitat while highlighting the important role that pollinators play in maintaining our ecosystem and food supply. East Tennessee State University began the awareness campaign and coordinated with downtown Johnson City to begin the development of a pollinator friendly corridor between the University and downtown.

The Johnson City Public Library, commercial/retail buildings and a future amphitheatre site border the King Commons park area. Within walking distance are inviting destinations such as Founders Park, Johnson City Public Library, the Pavilion (Farmers Market), and a variety of specialty shops and restaurants. Many pedestrians pass through King Commons park on their way to these surrounding destinations, and others linger in the park to enjoy the green space, walking paths, and art pieces.

## **PROJECT DESCRIPTION:**

As part of the City's sesquicentennial celebration this year, the City will add another dimension to King Commons park through the development of a natural adventure area/playground and a legacy plaza. The sesquicentennial sculpture will be commissioned by the City and installed in the center of the legacy plaza. Its radius must not exceed 7 ft. The sculpture must be lit at night or have light elements incorporated into the design, and it is preferred (but not required) that the sculpture is lit from within. The park is open 24 hours per day and is often

used at night, so the sculpture must be highly visible during the day and night and should activate the space that it occupies. The use of moving parts should be limited if not excluded; the sculpture should not have any fragile components and should be resistant to vandalism. It should be a substantial, durable and long-lasting piece. It is intended to be one of the main attractions within the park, creating a strong presence that draws pedestrians to the area and engages viewers.

It is the desire of the Johnson City Public Art Committee that the sculpture provide an interpretation of Johnson City's future possibilities, considering questions such as "Where is Johnson City going?" and "What type of values will Johnson City carry into the future?". In this way, the sculpture should become a visual representation of the City's 150<sup>th</sup> anniversary celebration while embodying the theme: "Hopes for the Future of Johnson City". Its design should convey a sense of growth, change, hope, happiness, and excitement, and it should take on a grandiose appearance to ensure the sculpture becomes a prominent feature in the park. Abstract or more literal interpretations of the sculpture theme will be considered. The legacy plaza that surrounds the sculpture will include references to Johnson City's past and will honor individuals from the City's history.

The selected artist will be responsible for providing design, fabrication and installation. The artist will coordinate with the City of Johnson City Public Works Department on installation. City crews will provide on-going maintenance and cleaning. In the qualifications statement, the artist shall demonstrate previous experience with installed pieces, similar in style and scale to this project. Three finalists will be selected to provide a more detailed proposal, including design concept, budget information and a maintenance plan.

**SITE MAP/LOCATION:**



Legacy Plaza & Surrounding Landscape

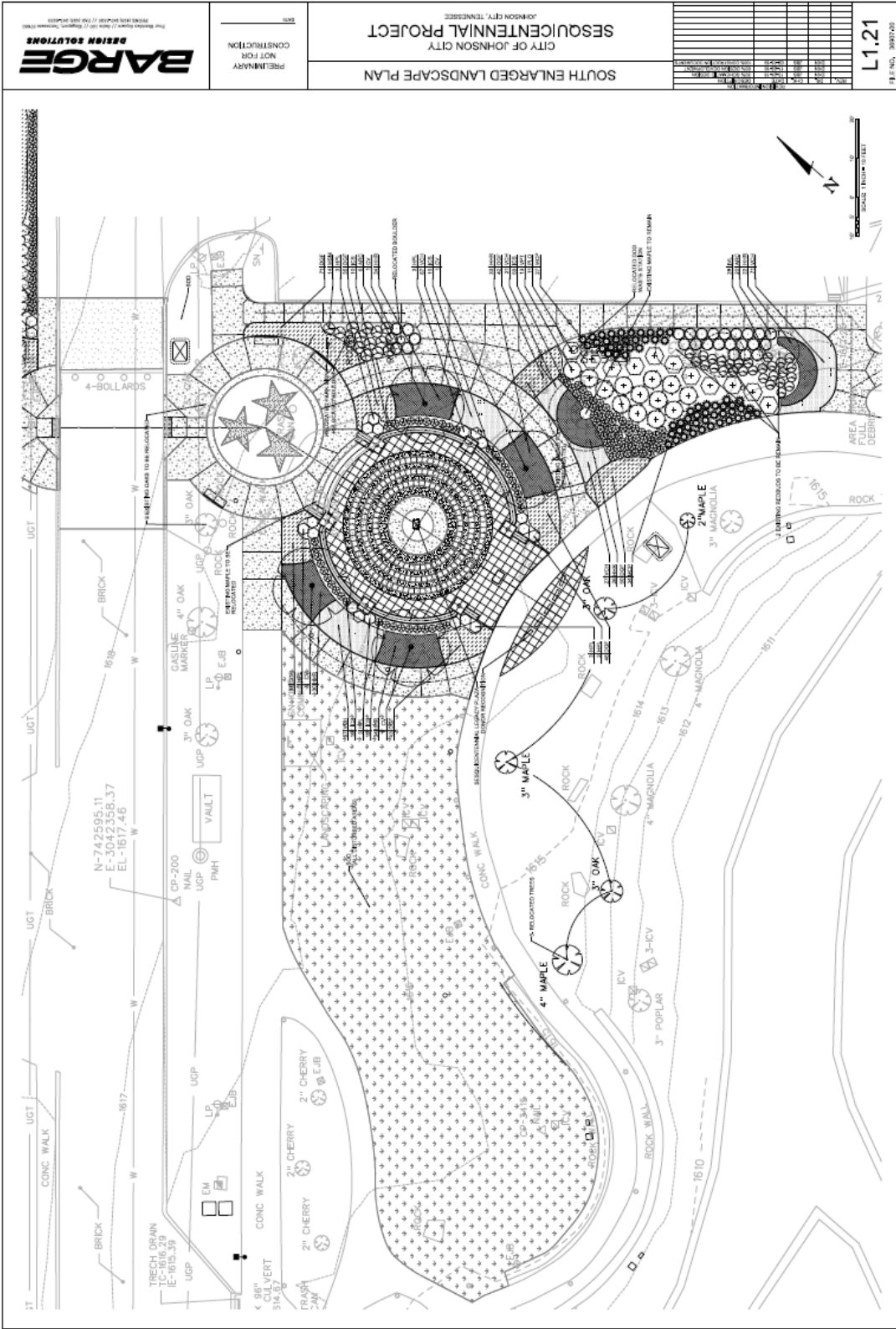

2/17/2018  
 10:00:23 PM  
 Landscape - Workspace Landscape

# Legacy Plaza Detail View

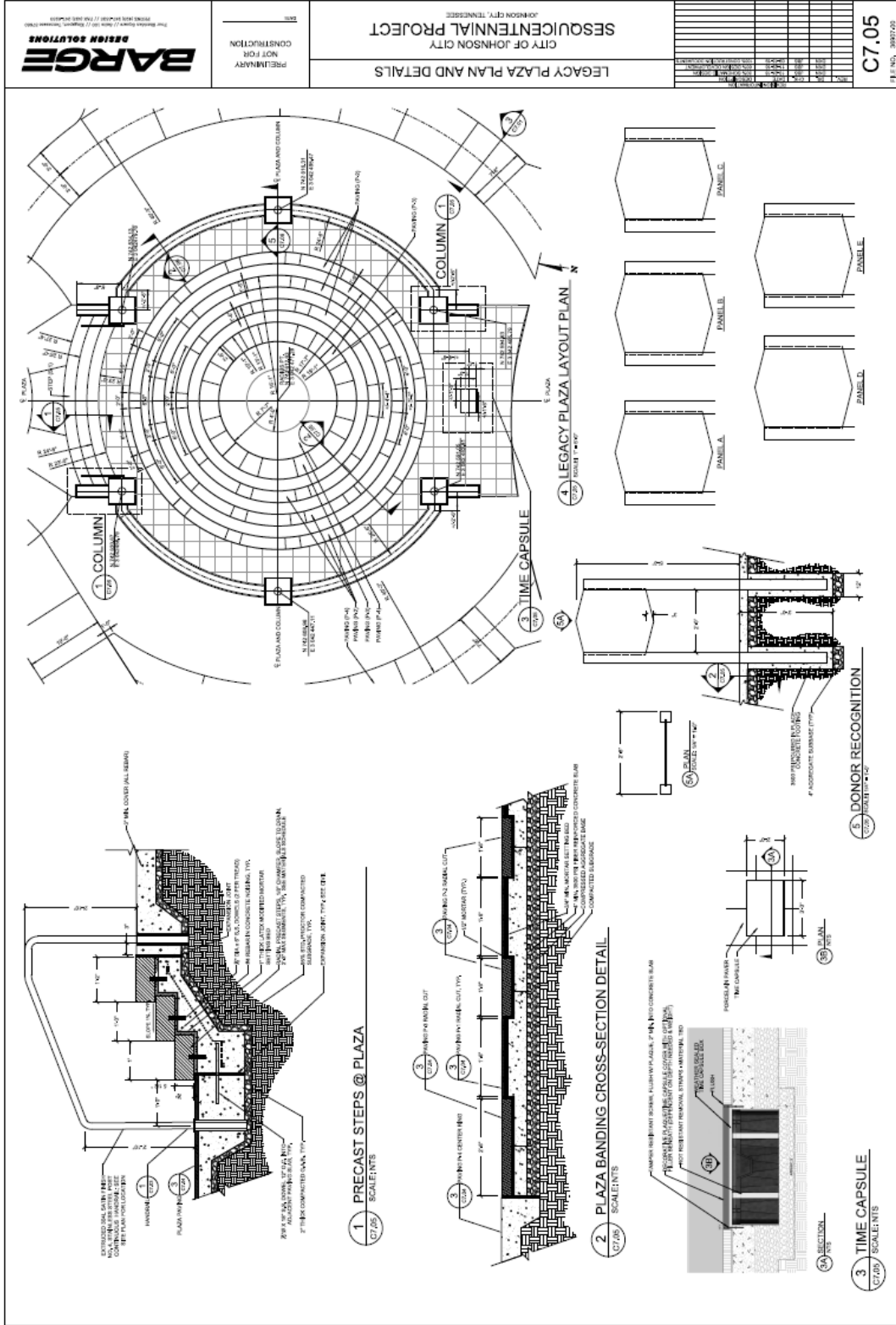

## **SELECTION CRITERIA:**

The Johnson City Public Art Committee will review the qualifications of applicant artists and will select three finalists. Their selections will be based on the following criteria:

- Artistic excellence as demonstrated in 10 digital images of the artist(s) previous work
- Experience in design and installation of projects of a similar type and scale
- Experience working in community settings
- Willingness to meet all contractual guidelines
- The use of content appropriate for all audiences

## **SUBMISSION GUIDELINES:**

Submit a digital packet using the online form at <https://jcpublicart.com/sesquicentennial-sculpture>. Submissions shall include the following:

- Cover letter/letter of intent
- Digital portfolio (10 digital images of previous artwork)
  - Include an image list with a thumbnail view of each image submitted – indicate the budget amount and provide a short description next to each thumbnail
- Artist's resume
- Contact information for 3 professional references (at least 2 should be from individuals who have commissioned public work from the artist)

## **PROJECT SCHEDULE:**

**Deadline for Application: April 19, 2019**

**Notification of Three Finalists: April 26, 2019**

**Finalist Proposals Due: May 31, 2019**

**Final Artist Selection: June 7, 2019**

The sculpture installation will take place by November 29th, 2019.

Installation will be scheduled in consultation with the City of Johnson City Public Works Department. When submitting your RFQ, please confirm that you can work within the timeframe noted above.



**LIST OF RESOURCES:**

**Phil Pindzola – Director, City of Johnson City Public Works Department**  
[ppindzola@johnsoncitytn.org](mailto:ppindzola@johnsoncitytn.org) 423-434-6080

**Cheyenne Kumbhare – Management Analyst, City of Johnson City Public Works Department**  
[ckumbhare@johnsoncitytn.org](mailto:ckumbhare@johnsoncitytn.org) 423-975-2706

**Submit a digital packet at <https://jcpublicart.com/sesquicentennial-sculpture>**